

FLOOR TRUSS LAYOUT DETAILS

KEITH TIMBER ~ 13 PARK TERRACE. KEITH 5267 Ph (08)8755-1233 Fax (08)8755-1443

Wednesday, 17 May 2017

03:00:15 PM



Phone: (08) 8755 1233
13 Park Terrace Keith S.A. 5267

Winner of Multiple FTMA Awards
Since 2007



INTERNAL SUPPORT LOCATION :	✕
TRUSS BOOT REQUIRED :	▽
HEAVY DUTY BEAM BRACKET :	▼
PROVIDE 120 x 35 MGP 10 END WEB BRACING :	✕
POST LOCATION :	■
POINT LOAD FROM WALL/ROOF :	⊕
OVERALL TRUSS HEIGHT :	400mm
TRUSS CENTRES :	600mm
FLOORING :	PARTICLE BRD 22mm
WET AREA OVERALL TRUSS HEIGHT:	355mm
TRUSS CENTRES:	450mm
FLOORING:	SCYON 19mm
BALCONY OVERALL TRUSS HEIGHT:	310mm
TRUSS CENTRES:	450mm
FLOORING:	SCYON 19mm

NOTE: ALL BEAM DESIGNS & BEAM TO BEAM CONNECTIONS BY ENGINEER/OTHERS

T = UPSTAIRS TOILET PENETRATION
F = FULLY SUPPORTED FLOOR TRUSS
W-A-S-J = WET AREA SIDE JOIST
BP = FLOOR TRUSS BEAM POCKET

WET AREA FLOOR AREA =
DRY AREA FLOOR AREA =
BALCONY AREA FLOOR AREA =

TRUSSES TO BE ERECTED & INSTALLED IN ACCORDANCE WITH MANUFACTURES DETAILS

FLOOR TRUSS INSTALLATION DETAILS REFER TO PRYDA TRUSS SYSTEMS GIUDE TO INSTALLATIONS

CANTILEVER SUPPORT

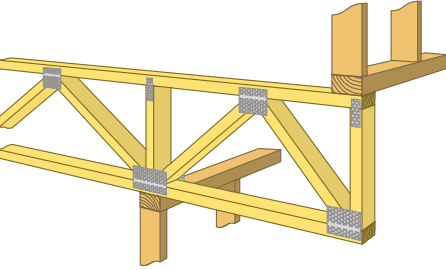

STANDARD END DETAIL TYPE 12
Overhang Any Length

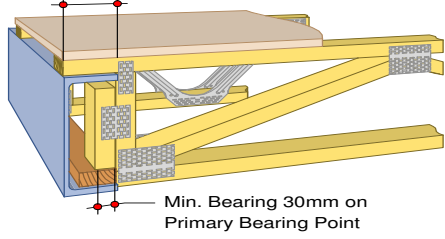

MULTIPLE FLOOR TRUSS FIXING

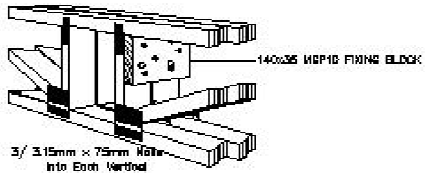

STANDARD END DETAIL TYPE 7

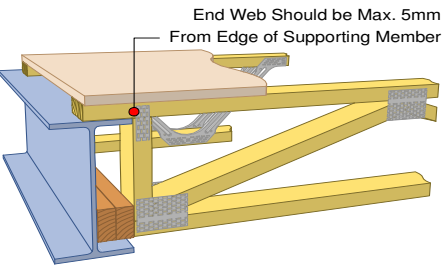

Table 10 – Bracing Unit Capacity

Pryda Strap Brace Code	Size	Method 1	Method 2
		Fixed to face and wrapped under the plate	Fixed only to face of plate
SB103	30 x 1.0 mm	4.8 kN	1.3 kN
SB123	32 x 1.2 mm	6.6 kN	1.3 kN

Notes:

- (i) Maximum angle of brace to top plate = 45°
- (ii) Method 1 fixing: 2/3.15 x 35 mm Pryda Timber Connector nails on face of plate and underside of plate
- (iii) Method 2 fixing: 2/3.15 x 35 mm Pryda Timber Connector nails on face of plate only
- (iv) 3/2.3 x 32 mm SHEG Duo-Fast machine driven nails (or equivalent) may be used in place of 2/3.15 x 35 mm Pryda Timber Connector nails

Product Codes

OSNGB = 3.15 x 35 mm Pryda Timber Connector nails
D40810 = 2.3 x 32 mm SHEG Duo-Fast machine driven nail

W-A-S-J

FITTED FLOOR FIXING -
SUPPLEMENTARY LEDGER PLATES

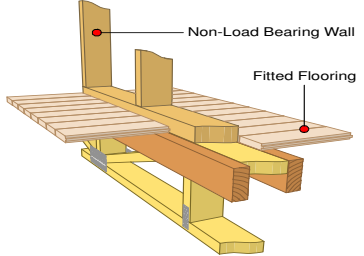

STRONGBACK SPLICE

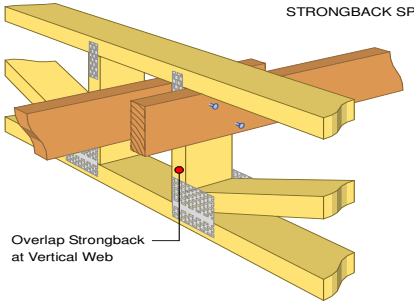

STANDARD END DETAIL TYPE 8

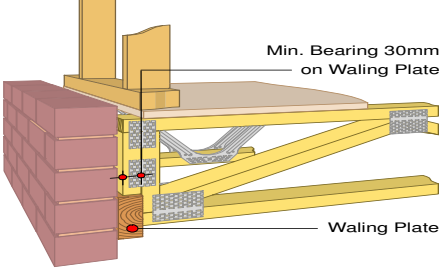

STANDARD END DETAIL TYPE 11

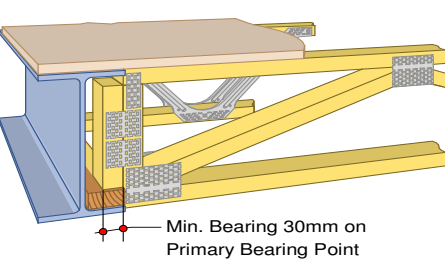

END FIXING DETAILS

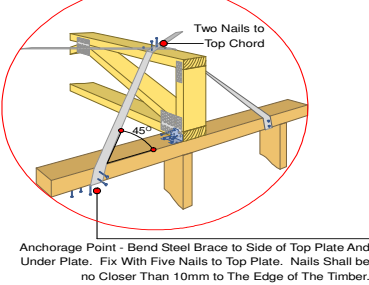

MULTIPLE FLOOR TRUSS FIXING

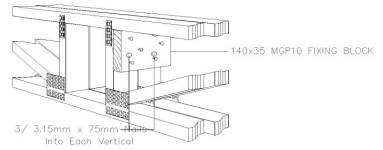

STANDARD END DETAIL TYPE 6

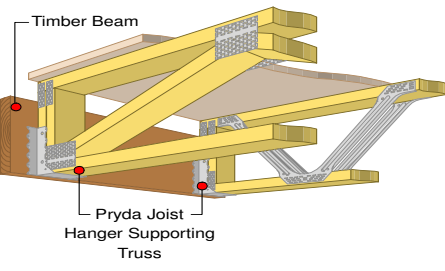

CANTILEVER - PARALLEL OFFSET UPPER
LOAD BEARING WALL

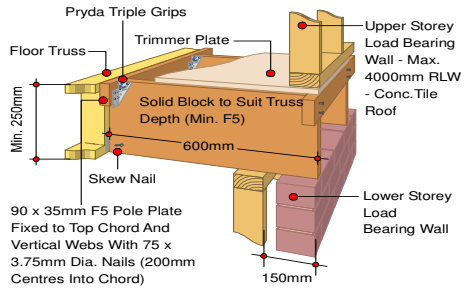

CENTRE GAP FOR MECHANICAL SERVICES

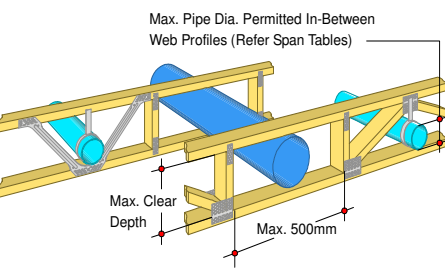

VOIDS ACCOMMODATING SERVICES

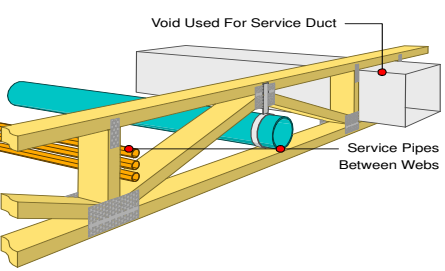

LONGREACH STRONGBACK

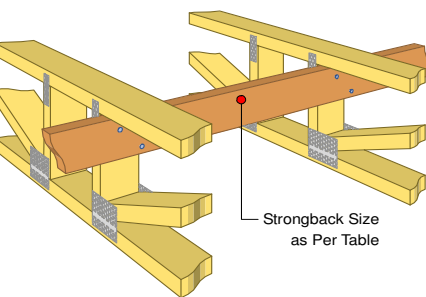

ALTERNATE STRONGBACK SPLICE

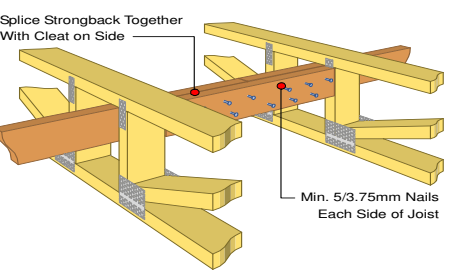

END BRACING FOR STABILITY

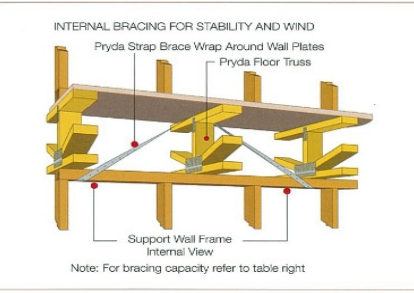
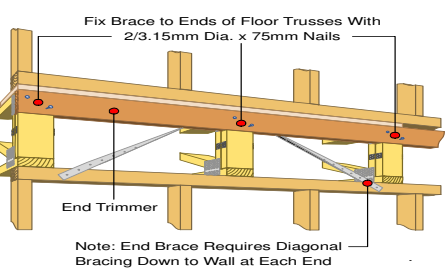

Fully Supported End Truss

Where the end floor truss is supported along its full length by a lower storey wall or by continuous base brickwork or footling while carrying an upper storey wall above, a simplified floor truss, as shown, may be used.

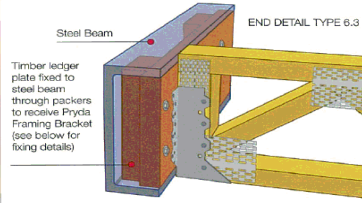
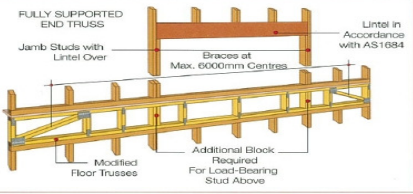

Note: Timber ledger plate (min. 190x35) should be fully bearing on bottom flange of steel beam, and usually fixed to web of beam through packers at 900mm c/c using 2/M10 bolts. Contact a Project Engineer for verification of fixing for commercial application.

SINGLE WEB SUPPORT

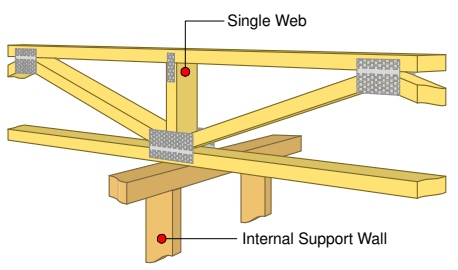

	Customer : Pine Timber (Acc 1) Site Address : BERT FARINA CONSTRUCTION : 147 MARION ROAD, RICHMOND	Flooring : 75mm Hebel SoundFloor Floor Spacing : 600 Detailer : Adam Koziol	Job Ref 16-1021B Scale 1:100 Level LEVEL
--	--	---	--

NO ADDITIONAL LOADS ALLOWED FOR I.E WATER BEDS / SPA BATHS / POOL TABLES ETC. UNLESS SHOWN ON LAYOUT